

THREE-WAY TIPPER AND DUMPER
NOVEMBER 2024

GB



WWW.FLIEGL.COM

MEMBER OF



INNOVATIVE BY TRADITION

The name Fliegl has a decades-long reputation for quality, innovative action, and practical solutions for agriculture. These are advantages which have made Fliegl the No.1 In Europe, for example in the agricultural trailers sector. Whether it's for tippers, original push-off trailers, slurry technology or harvest logistics:

FLIEGL ALWAYS HAS THE OPTIMUM TRANSPORT CONCEPT FOR YOU.





One-axle three-way tipper

from 2.6 to 8 t total weight



Advantages

- Robust hollow section frame
- Low centre of gravity
- Low net weight
- Nevertheless extremely robust and torsion-resistant
- Galvanised frame
- High stability
- Compact design
- High manoeuvrability
- Large tilt angle
- Available with side wall extensions





EDK 25 with leaf protection top piece



All tipper frames are hot-dip galvanised as standard
...suitable for any tractor size!



Equipment for EDK

Frame:
weight optimised frame for maximum payload

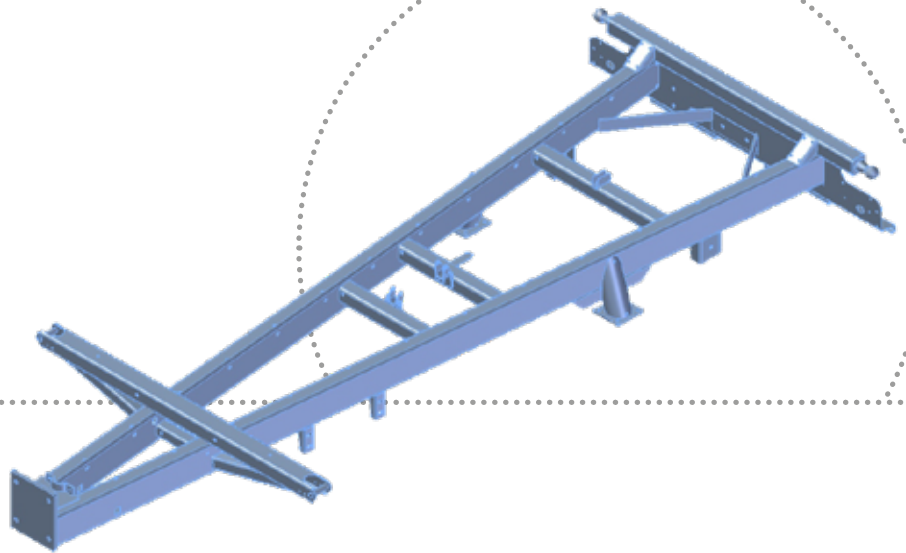

Bridge:
plug-in corner stanchions,
all-round rubber seal in special rubber profile
(starting from EDK 60)

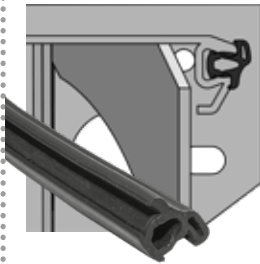

Basic tailgate:
steel tailgates, sandblasted,
primed and powder-coated



2 five-chamber lights with shock-resistant glass

Grain outlet starting from
EDK 40



Large tilt angle

Optional:
body 500 mm with ladder



Large-size axle with wide track for best stability

Hollow section frame, galvanised

Heavy-duty support wheel, folding

Braking systems:
not braked
Parking brake
Overrun brake
Hydraulic brake
Compressed air brake

Two-axle three-way tipper

with total weight from 6 to 18 t



Top chassis!

- Bridge made of high-grade steel - sandblasted, dipcoat primed with two-component coating
- Galvanised, continuously formed frame, made with high-quality fine-grained steel (welded structure)
- Heavy-duty suspension
- Heavy-duty truck type slewing ring
- Galvanised frame optional





DK 180-88 XL

- With centre stanchions
- Parabolic suspension, lubrication-free
- Bridge 5,250 x 2,320 x 800 mm
- Body 600 mm or 800 mm



DK 180-88 Maxum:

- Parabolic suspension, lubrication-free
- Bridge 5,050 x 2,420 x 800 mm
- Body 600 mm or 800 mm



Roll-out tarpaulin with optional platform

Three-axle DDK three-way tipper

with total weight 24 t

- Bridge length: 6.20 m / 7.20 m or 7.80 m
- Accessories: Platform
- Accessories: Tarp frame with roll-out PVC tarp



Advantages

- 3-axle three-way tipper, 24 t total weight with centre stanchion
- Bridge with high-grade steel – sandblasted, dipcoat primed with two-component coating
- Continuous frame (welded structure)
- Heavy-duty suspension, parabolic suspension, lubrication-free
- Heavy-duty, truck type slewing ring
- ALB



DDK 310 three-axle three-way tipper

The grain master! Combines the benefits of a three-axle tipper with the payload and traction of a tridem tipper

Details

- Perm. total weight 31,000 kg
- Bridge: 8200 mm x 2320 mm
- Highly manoeuvrable thanks to three-axle chassis
- Roll-off tarpaulin with optional platform possible
- Tyres: 560/45 R 22.5 possible
- 420 mm x 250 mm grain hatch possible
- Swivelling draw gear for top or bottom attachment
- Lateral potato/beet slide possible



Central locking as STANDARD:
left, right and rear



High tipping angle

DK equipment

Frame:
weight-optimised frame from the utility vehicle division for perfect ground adaptation

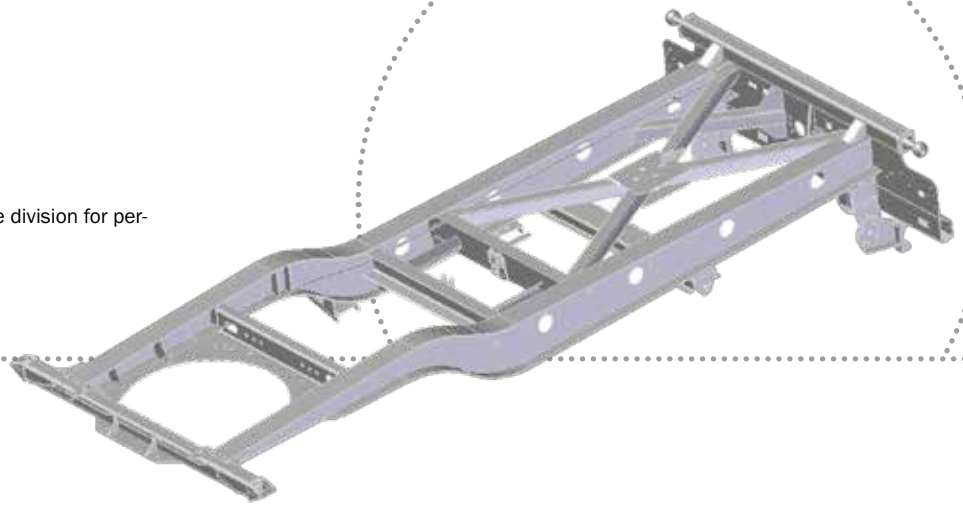

Bridge:
plug-in corner stanchions, all-steel floor, all-round rubber seal in special profile, bridge frame made with high-grade steel sections, torsion-resistant and stable

Basic tailgate:
central locking rear, right and left, steel tailgates sand-blasted, primed and powder-coated



Optional: Structure

2 five-chamber lights with shock-resistant glass
Optional: LED

Optional:
trailer coupling rear, 8 t or automatic up to 18 t

Rear grain slider



Large tilt angle

Optional:
tarp frame with PVC tarp



Optional:
Body with ladder

Optional:
platform

Optional:
tailgate tension spring

Series:
V-drawbar

Optional:
Y-drawbar

Frame as welded structure

Tandem three-way tipper

from 8 to 20 t total weight



TDK 160 with 1800 mm body
(3 x 600 mm tailgate)



TDK with hydraulic gravel flap 500 mm



Robust flap with 2-cylinder design



Retractable lashing eyes



- Tandem tipper with hollow section frame proven thousands of times over
- Tapered bridge, length starting from 4,500 mm
- Tilt angle (up to 55° possible) for best run-out of any kind of bulk goods
- Robust: tailgates integrated in the automatic and the hydraulic back wall allow grain transport even with the silage body
- Grain slider as standard (except TDK 110 S und 140 S)
- Front viewing grille on silage body as standard
- Extra-large axle gauge ensures outstanding stability on any terrain
- Particularly low platform height
- Side walls can be opened for loading



Silage tipper with hydraulic back wall



40 km/h version with underride guard and mudguards



Side wall support

Frame and TDK body

Fliegl tippers starting from the TDK 130 Series are fitted with a durable Titan tandem assembly which has been proven thousands of times over – for optimal ground compensation up to 30 cm.

Unique: The Fliegl wide-gauge chassis for greater stability!

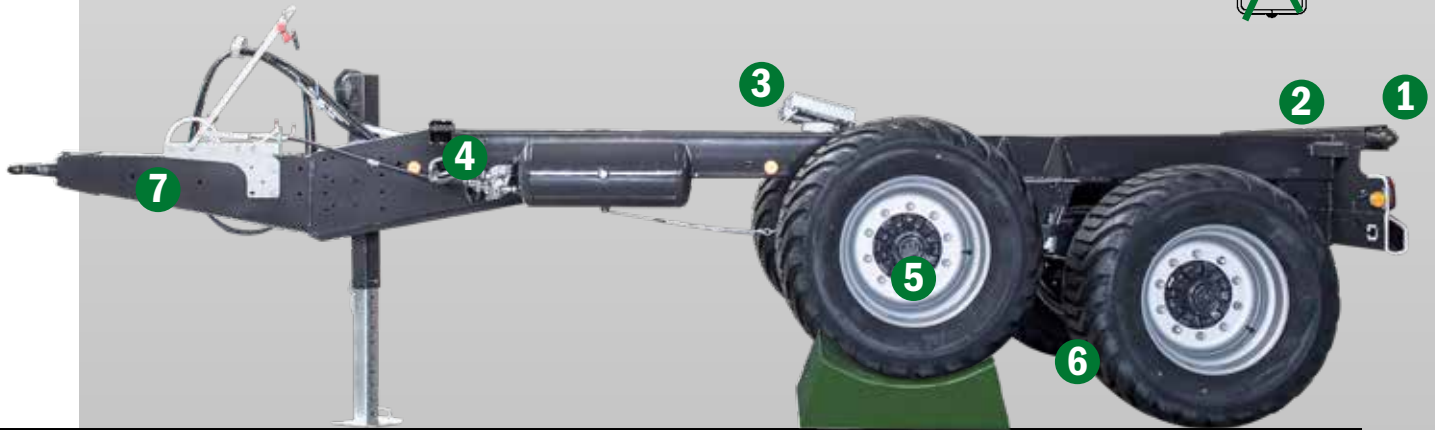
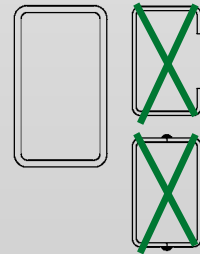

- 1 Large-size tilt ball bearing, extremely wide on the outside, for best stability.
- 2 Continuous, robust tipping cross bar, with extra-wide bearing at the rear.
- 3 Large-size tilt cylinder (gimbal mounting).
- 4 Extra-strong hollow section frame: (no welded U-profiles) ensures maximum stability (absolute torsion-resistance), so no warping is possible.
- 5 Heavy-duty axles with plenty of reserve.
- 6 Extra-large track width for unparalleled stability on challenging terrains.
- 7 Swivelling drawbar for top or bottom hitch.



Gigant tandem assembly - parabolic suspension



Titan tandem assembly for best ground adaptation, lubrication and maintenance free.



Perfection already at production!

- Steel tailgates - sandblasted, primed and powder-coated
- Basic tailgate starting from 4.5 m, extra reinforcement with socket pipes

Extremely robust body for the toughest jobs...

- ① Heavy-duty corner stanchions.
- ② Adjustable tailgate tightener (option).
- ③ Heavy-duty cross bridge for optimal overloading weight.
- ④ Additional hard rubber cushion.
- ⑤ Heavy-duty bridge frame for extreme torsion resistance.



Absolutely secure!

- Tilt ball bearing at rear
- Two ball sockets with polyamide inlay on tempered ball heads, noise-absorbing, maintenance-free, low-wear, and centred exactly.
- The pivot pins are made so that any crossover points are excluded.

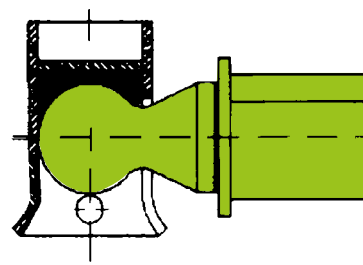

TDK equipment

Optional:
Hydraulic back wall
with integrated tailgates

Bridge (tapered):

Plug-in corner stanchions, steel floor,
all-round rubber seal in special profile

Basic tailgate:

Socket pipe, central locking rear, right and left, tight-
ening strap, steel tailgates sandblasted, primed and
powder-coated



2 Fünfkammerleuchten mit schlagfestem 2 five-chamber
lights with shock-resistant glass
Optional: LED Glas

Grain outlet

Optional structural items available

Large tilt angle



Optional: grating front panel as standard in connection with hydr. back wall

Optional: body with ladder

DIN drawbar eye 40 mm

Traction bar without suspension, swivelling for top or bottom hitch

Profi frame galvanised

Available:
• Heavy-duty support wheel, folding
• Support leg with 2 speeds,
• Hydraulic support leg

Tandem chassis, "Titan" tandem vehicle assembly with parabolic suspension

Technical data Three-way tipper

EDK | DK | DDK

One-axle three-way tipper

		EDK 20	EDK 25	EDK 40
Total permitted weight:	kg	2.250	2.750	4.000
perm. drawbar load	approx. kg	250	250	1.000
Bridge size inside L	approx. mm	2.000	2.500	3.000
Bridge size inside W	approx. mm	1.200	1.500	1.600
Tailgate height	approx. mm	400	400	400
Bridge tapered				
Platform height approx. 1)	mm	720	800	850
Track width	mm	1.000	1.250	1.350
Tyres 2)		10/75/15	10/75/15	10/75/15
Tilt cylinder stroke	mm	900	900	900
Required oil quantity	approx. ltr.	4	4	7
Rear central locking				Serie
Side central locking				

Two-axle three-way tipper

		DK 60	DK 80	DK 110-88	DK 140-88
Total permitted weight:	kg	6.000	8.000	11.000	14.000
Bridge size inside L	approx. mm	4.000	4.500	4.500	4.500
Bridge size inside W	approx. mm	2.000	2.220	2.220	2.220
Tailgate height	approx. mm	500	500	500	500
Bridge tapered			Serie	Serie	Serie
Platform height approx. 1)	mm	1.050	1.200	1.250	1.300
Track width	mm	1.650	1.850	1.850	1.850
Tyres 2)		10/75/15	11,5/15	12,5/80/18	385/65/22,5 RE
Tilt cylinder stroke	mm	1.500	1.850	1.850	1.850
Required oil quantity	approx. ltr.	12	14	14	16,5
Rear central locking		Serie	Serie	Serie	Serie
Side central locking		Serie	Serie	Serie	Serie
Centre stanchions					

1) depending on version and in the loaded state

2) other tyres on request

Other special equipment on request

EDK 50	EDK 60	EDK 65	EDK 80 -4000	EDK 80 -4500
5.500	6.000	6.000	8.000	8.000
1.000	1.000	1.000	1.000	1.000
3.500	4.000	4.000	4.000	4.500
1.800	2.000	2.200	2.200	2.200
400	500	500	500	500
				Serie
880	980	1.050	1.180	1.180
1.450	1.650	1.850	1.850	1.850
11,5/15	15/55/17	12,5/80/18	385/65/22,5 RE	385/65/22,5 RE
1.200	1500	1.500	1.500	1.850
7	12	12	12	14
Serie	Serie	Serie	Serie	Serie
	Serie	Serie	Serie	Serie

Three-axe three-way-tipper

DK 160	DK 140-88-5	DK 180-88	DK Max. 180-88	DDK 240-6,20	DDK 240-7,20	DDK 240-7,80
16.000	14.000	18.000	18.000	24.000	24.000	24.000
4.500	5.000	5.150	5.050	6.200	7.200	7.800
2.320	2.320	2.420	2.420	2.320	2.320	2.320
800	600	800	800	800	800	800
Serie	Serie					
1.300	1.300	1.350	1.350	1.400	1.400	1.400
1.850	1.850	1.950	1.950	1.950	1.950	1.950
385/65/22,5 RE	385/65/22 RE	385/65/22,5 RE	385/65/22,RE	385/65/22,5 RE	385/65/22,5 RE	385/65/22,5 RE
1.850	2.150	2.000	2.000	2.250	2.250	2.500
16,5	20	28	28	35	35	40
Serie	Serie	Serie	Serie	Serie	Serie	Serie
Serie	Serie	Serie	Serie	Serie	Serie	Serie
		Serie		Serie	Serie	Serie

Technical data TDK

Tandem three-way tipper

		TDK 80	TDK 80-88	TDK 110-88
Total permitted weight	kg	8.000	8.000	11.000
perm. drawbar load	approx. kg	1.000	1.000	2.000
Bridge size inside L	approx. mm	4.000	4.500	4.500
Bridge size inside W	approx. mm	2.200	2.220	2.220
Tailgate height	approx. mm	500	500	500
Bridge tapered			Serie	Serie
Platform height approx. 1)	mm	1.150	1.150	1.180
Track width	mm	1.850	1.850	1.850
Tyres 2)		11,5/15	11,5/15	12,5/80/18
Tilt cylinder stroke	mm	1500	1.850	1.850
Required oil quantity	approx. ltr.	12	14	14
Rear central locking		Serie	Serie	Serie
Side central locking		Serie	Serie	Serie

Tandem three-way tipper with hydr. gravel flap

		TDK 110 S	TDK 140 S	TDK 160 S
Total permitted weight	kg	11.000	14.000	16.000
perm. drawbar load	approx. kg	2.000	2.000	2.000
Bridge size inside L	approx. mm	4.500	4.500	5.000
Bridge size inside W	approx. mm	2.320	2.320	2.320
Tailgate height	approx. mm	500	500	600
Bridge tapered				
Platform height approx. 1)	mm	1.180	1.300	1.300
Track width	mm	1.850	1.850	1.850
Tyres 2)		19/45-17 14 PR	355/60 R18	385/65/22,5
Tilt cylinder stroke	mm	1.850	1.850	2.150
Required oil quantity	approx. ltr.	14	16,5	20
Rear central locking		Serie	Serie	Serie
Side central locking		Serie	Serie	Serie

1) depending on version and in the loaded state

2) other tyres on request

Other special equipment on request

TDK 140-88	TDK 160	TDK 200	TDK 200XL
14.000	16.000	20.000-21.000	20.000-23.000
2.000	2.000	2.000	2.000
4.500	5.000	5.000	5.150
2.220	2.320	2.320	2.320
500	600	600	800
Serie	Serie	Serie	Serie
1.300	1.300	1.350	1.350
1.850	1.850	2.050	2.050
15/70/18	385/65/22,5 RE	385/65/22,5 RE	385/65/22,5 RE
1.850	2.150	2.150	2.150
16,5	20	28	28
Serie	Serie	Serie	Serie
Serie	Serie	Serie	Serie



TMK dumper

Fliegl dumpers are distinguished by their greater diversity, innovative details with know-how from the Fliegl utility vehicle production, and customised versions for special applications.



With tapered body for complete emptying



Mechanically folding protective grating



standard starting from TMK 256:
hydraulic drawbar suspension and drop support leg, mechanical



Galvanised body, folding

Other advantages:

- Low net weight for more loading capacity
- Unique Fliegl wide-gauge chassis for best stability
- Titan tandem assembly proven thousands of times over, for optimal ground compensation up to 30 cm
- Various assemblies available
- Heavy-duty, powerful underride guard with protected lighting

TMK Potato

- Body height 1250 mm
- Jumbo chassis
- Body length 6.60 m
- Large grille with removable inspection panel



Long overhang at TMK Potato
Filling bunkers



- Pull-out ladder
- Series: front inspection window



For gravel and soil transport:
TMK 130S

Dumper TMK Profi

With round front wall and volume rear flap starting from TMK 264

More volume thanks to compact shape and short frame design



Roll-off tarpaulin can be operated from the ground, only possible in conjunction with a 400 mm aluminum body.

Dumper TMK Profi 279 and 386



Volume approx. 48 m³

Volume approx. 42 m³

TMK 279

Details

- Body size: 8600 mm (7900 mm at TMK 279) x 2,320/2220 mm (conical) x 1750 mm incl. front wall bevelling and large rear wall
- Air suspension or hydraulic suspension possible
- Low centre of gravity due to special frame construction
- TopLift light load securing system, mounted on body extension 500
- Various body attachments (400, 500 or 600 mm possible)
- Hydraulically sprung drawbar for bottom hitching
- Tyre size 710/50 R 30.5" possible

Schwergut Muldenkipper TMK S

TMK 200 S XL*



Hydraulische Rückwand
ab TMK 200 S XL
Verzinkter Aufbau klappbar



3 paar Zurrösen im
Brückenboden versenkt
(bei TMK 130 S bis TMK 200 S XL)



Großzügiger Kippwinkel



TMK 200 S*

* Abbildungen mit Sonderlackierung,
Serienlackierung in dunkelgrün.



Schotterklappe bei TMK 130 S und
TMK 200 S



Schwerer Brückenrahmen
für extreme Verwindungssteifheit



Verstärkungsprofile aus einem
Stück gekantet und gerundet

TMK 266 S

der Allrounder im Transport
(Getreide/Silage ...Kies usw.)



Details

- Halfpipe-Mulde aus hochfestem Stahl S 700 MC
- Seitlich abklappbarer Muldenaufsatz 500 mm
- Bereifungsgröße: 650/55 R 26
- TMK 266 S Profi: Niedriger Schwerpunkt durch Jumbo-Aggregat Gigant Plus
- TMK 375 S Profi: Hydraulische Federung
- Zugeinrichtung hydraulisch gefedert
- Zugeinrichtung drehbar für Oben- bzw Untenanhängung

TMK 375 S Profi



Bei TMK 266 S und 375 S
inkl. Kornschieber



Zugeinrichtung hydraulisch gefedert



2-Achs Sattelaufleger mit ALU-Mulde

Gesamtgewicht 31.000 kg / Achslast hinten bis 20.000 kg

- Volumen 49 m³
- Luftfederung mit Kippabsenkung
- Aluminium-Kastenmulde konisch
- 60 oder 80 km/h Ausführung
- Bereifung 600/55 R 26,5“
oder 24 R 20,5“



Doppelgelenkscharnier und
2-fache Hakenverriegelung

Schräge Stirnwand, Seitenwände aus
30 mm Hohlkammerprofilen mit
schüttgutabweisendem Oberholprofil





4 Spanschlösser für Gerteidettransport sowie Abladung über Kornschieber. Umlaufende Gummidichtung in Verbindung mit Spanschlössern auch für feuchte Schüttgüter.

Volumen ca. 49 m³

Hydraulisches Klappdach TopLift light: mit Netzabdeckung zur Ladungssicherung



2-Achs Hinterkipp Sattelaufleger ZHKA 350

zul. Gesamtgewicht	kg	31.000
Anzahl Achsen		2
angenommene Aufsattellast	kg	11.000
Aufsattelhöhe +/- 50 mm	mm	1.400
Eigengewicht	ca. kg	000000
Muldenlänge innen	mm	9.300
Muldenbreite innen/konisch	mm	2.150/2.420
Muldenhöhe innen	mm	2.470
Plattformhöhe bei Serienbereifung	ca. mm	1.550
Spurweite*	mm	2.050
Bereifung		600/55 R 26,5
erforderliche Ölmenge	Liter	38

TMK frame and body

Unique:

The Fliegl wide-gauge chassis for greater stability!

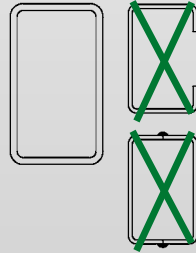

- 1** Large size tilt ball bearing up to body size 5.15 m for optimum stability.
- 2** All Bull bodies and dumpers starting from TMK 256 have a heavy-duty tilt bearing mounted directly on the frame
- 3** Continuous, robust tipping crossbar, extra-wide bearing at the rear.
- 4** Large-size tilt cylinder (gimbal mounting).
- 5** Specially strong hollow section frame: (no U-sections welded together) ensure maximum stability (absolute torsion resistance), so warping of the frame is not possible.
- 6** Heavy-duty axles with plenty of reserve.
- 7** Extra-large track width for unparalleled stability on challenging terrains.
- 8** Swivelling drawbar for top or bottom hitch.



Always variable – the Fliegl Profi frame!

- Standard starting from TMK 140
- Swivelling drawbar for top or bottom hitch
- Drawbar with suspension (standard starting from TMK 256 body length 5650 mm)



- 1 Heavy-duty cross bridge for optimal overloading weight
- 2 Heavy-duty bridge frame for extreme torsion resistance
- 3 Reinforcement sections edged and rounded from one piece
- 4 Side walls shaped from one piece
- 5 Large tilt angle



Gigant tandem assembly (TMK 200 starting from 5.65 m body length)



Tandem assembly "Gigant Plus"



Titan tandem assembly for best ground compensation.

TMK equipment

Optional:
body top piece

Body:
tapered, all steel

2 five-chamber lights with shock-resistant glass
Optional: LED

Grain outlet



Large-sized tilt angle

ca. 55°

Hydraulic back wall

Series:
inspection window and ladder

Kugelkopf

Profi frame galvanised
Swivelling drawbar for top
and bottom hitch



Technical data

One-axle/tandem/tridem dumper

Heavy-duty dumper

TMK 130 S		
Total permitted weight:	kg	13.000-14.000
perm. drawbar load	kg	4.500
Body inside length	mm approx.	2.300
Body inside width	mm approx.	500
Body inside height	mm approx.	nein
Bridge tapered		1.250
Platform height approx.	mm	1.850
Track width	mm	15/70-18 16 PR
Tyres		1.850
Tilt cylinder stroke	mm	16,5
Required oil quantity approx..	l	ja
Hydraulic back wall		

Kornschieber

One-axle dumper

		EMK 80	EMK 110
Total permitted weight including perm. drawbar load	kg	8.000	11.000
Body inside length	mm approx.	4.650	4.650
Body inside width	mm approx.	2.320	2.320
Body inside height	mm approx.	1.300	1.300
Bridge tapered		ja	ja
Platform height approx.	mm	1.300	1.300
Track width	mm	1.850	2.050
Tyres		385/65-22,5 RE	385/65-22,5 RE
Tilt cylinder stroke	mm	1.850	1.850
Required oil quantity approx..	l	15	15
Hydraulic back wall		yes	yes

Tandem dumper

		TMK 200-5,15	TMK 256	TMK 264
Total permitted weight including perm. drawbar load	kg	20.000 - 21.000	20.000 - 23.000	20.000 - 24.000
Body inside length	mm approx.	4.100	4.550	5.200
Body inside width	mm approx.	5.150	5.650	6.400
Body inside height	mm approx.	2.320	2.320	2.320
Bridge tapered		1.500	1.500	1.500
Platform height approx.	mm	ja	ja	ja
Track width	mm	1.300	1.400	1.400
Tyres		2.050	2.050	2.050
Tilt cylinder stroke	mm	385/65-22,5 RE	385/65-22,5 RE	385/65-22,5 RE
Required oil quantity approx..	l	2.150	2.455	2.455
Hydraulic back wall		28	28	32
Hydraulische Rückwand		ja	ja	ja

TMK 200 S	TMK 200 S XL	TMK 266 S PROFI	TMK 375 S PROFI
20.000-21.000	20.000-21.000	20.000-22.000	30.000-31.000
5.000	5.000	6.500	7.500
2.300	2.300	2.220	2.220
900	900	1.650	1.650
nein	nein	nein	nein
1.300	1.300	1.500	1.500
2.050	2.050	2.050	2.050
385/65-22,5 RE	385/65-22,5 RE	650/55 R 26.5	650/55 R 26.5
2.150	2.150	2.950	3.400
28	28	35	39
ja			
	ja	ja	ja
		ja	ja

TMK 80	TMK 110	TMK 140	TMK 160	TMK 190
8.000	11.000	14.000	16.000	19.000
4.650	4.650	4.650	5.150	5.950
2.320	2.320	2.320	2.320	2.320
1.300	1.300	1.300	1.500	1.500
ja	ja	ja	ja	ja
1.100	1.100	1.250	1.250	1.250
1.850	1.850	2.000	2.000	2.000
12,5/80 -18	12,5/80 -18	385/65-22,5 RE	385/65-22,5 RE	550/60-22,5 16 PR
1.850	1.850	1.850	2.150	2.150
15	15	16,5	20	20
yes	yes	yes	yes	yes

Tridem dumper

TMK 269	TMK 273	TMK 279	TMK 373	TMK 378	TMK 386
20.000 - 24.000	21.000 - 24.000	23.000 - 24.000	29.000 - 33.000	29.000 - 33.000	33.000 - 34.000
5.600	5.800	6.000	6.200	6.350	6.750
6.900	7.400	7.900	7.400	7.900	8.600
2.320	2.320	2.320	2.320	2.320	2.320
1.500	1.500	1.500	1.500	1.500	1.500
ja	ja	ja	ja	ja	ja
1.400	1.400	1.400	1.400	1.400	1.400
2.050	2.050	2.050	2.050	2.050	2.050
385/65-22,5 RE	385/65-22,5 RE	710/50 R 30.5	385/65-22,5 RE	385/65-22,5 RE	650/55 R 26.5
2.950	3.400	3.400	3.400	3.400	3.400
35	39	39	39	39	39
ja	ja	ja	ja	ja	ja

Fliegl Agrartechnik GmbH

Bürgermeister-Boch-Str. 1 | D-84453 Mühldorf a. Inn
Tel.: +49 (0) 86 31 307-0 | Fax: +49 (0) 86 31 307-550 | e-Mail: info@fliegl.com

Dimensions, weights, and technical data are subject to modification.

Some illustrations show special equipment.

Three-way tipper and dumper 11-2024



WWW.FLIEGL.COM